

2026 JAMES D. MACCONNELL AWARD

THE WILD

Wildcat Innovative Learning Destination

GODLEY ISD | GODLEY, TEXAS

Huckabee
a MOREgroup brand



EXECUTIVE SUMMARY

Efficiency by Design

No wasted space. That was the goal for Godley ISD, and The Wildcat Innovative Learning Destination (The WILD) is the result.

The WILD is a four-story Career and Technical Education (CTE) facility embedded within the home side of the district's football stadium. The WILD transforms what would traditionally be single-use, event-driven space used about six nights in the fall, into a constantly active hub for year-round learning and community use.

Rather than separating academics, athletics, and gathering spaces into standalone buildings that sit empty during most weekdays, The WILD merges them into one cohesive, future-ready destination where every square foot works harder. Shared, adaptable spaces support both daily instruction and large-scale events and extend the value of the facility far beyond game day.

Designed for real-world learning, The WILD supports eight career clusters including IT, business, agriculture, education, manufacturing, transportation logistics, health science, human services, and A/V, while incorporating outdoor classrooms and flexible environments that expand how and where students learn.

The result is a bold generational investment for Godley ISD: a first-of-its-kind facility that keeps students, programs, and the community actively engaged while setting a new standard for multi-use educational design.



SCOPE OF WORK & BUDGET

OWNER

Godley ISD

LOCATION

Godley, Texas

PROJECT TYPE

New Construction,
Expansion & Renovation

BUILDING AREA

77,850 sf
26,655 sf dual purpose

PROJECT COST

\$42,710,334 Const. Cost

\$549 /sf

OCCUPANCY DATE

04.15.24

STUDENT CAPACITY

500 Students

GRADES SERVED

9th - 12th Grade



**8 Career and
Technology
Pathways Served**



**40 Indoor and
Outdoor Learning
Spaces**



**Over 300 Industry-Based
Certifications Earned in
One School Year**



**34% of the Building's
Square Footage is
Multipurpose**



**\$55 Million Saved
by Combining
Facilities**

A Growing Community

With a rapidly growing population and an influx of new families, Godley ISD is a district shaped by expansion, high expectations, and a strong sense of community pride. Located just 30 minutes from downtown Fort Worth, Godley has maintained its rural character, with wide-open land, dark night skies, and strong turnout at high school events.

As part of its 2021 bond program, the district identified the need to support continued growth through expanded academic space, enhanced Career and Technical Education (CTE) opportunities, and improved athletics facilities. At the same time, the community emphasized the importance of maximizing value and being responsible stewards of taxpayer investment—seeking solutions that would serve students while also benefiting the broader public.

Godley at a Glance



Godley, Texas is located **30 miles southwest** of Fort Worth, TX



Godley's student population has **grown 87%** since 2016.



Godley's population is estimated to be **5,834** as of 2026.

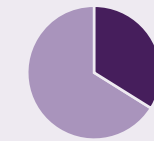

34% of Godley students are **economically disadvantaged**.



Engaging the Godley Community

To guide these priorities, the district engaged a wide range of stakeholders, including the Board of Trustees, district leadership, campus administrators, teachers, CTE program leaders, students, and a dedicated Facilities Planning Committee. These groups played an active role in shaping the project's direction, ensuring that evolving needs, diverse perspectives, and long-term community goals were reflected in the decision-making process. From there, our team came up with the concept of the WILD to efficiently utilize space and create a solution that can serve all stakeholders of the community.

Challenges

The district faced a complex set of challenges that required rethinking traditional approaches to school design.

Rapid growth created immediate demand for expanded academic and CTE space, while also highlighting the need for improved athletics and community facilities. At the same time, the project was constrained by a limited and irregular site and existing facilities already in place, budget pressures, and the expectation to maximize long-term value.

The process was further impacted by pandemic-era collaboration, which limited in-person engagement, and by material shortages and cost escalation that influenced structural decisions during design and construction. This also demanded a concise building footprint. We had to combine more into less to make the budget work.

DISTRICT-WIDE STUDENT ENROLLMENT PROJECTED TO NEARLY TRIPLE IN THE SPAN OF 18 YEARS

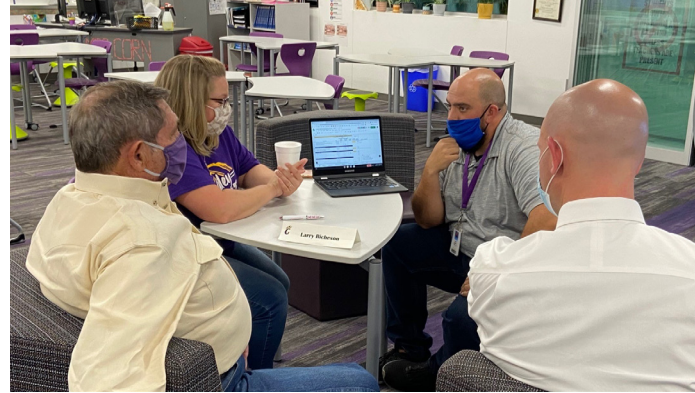
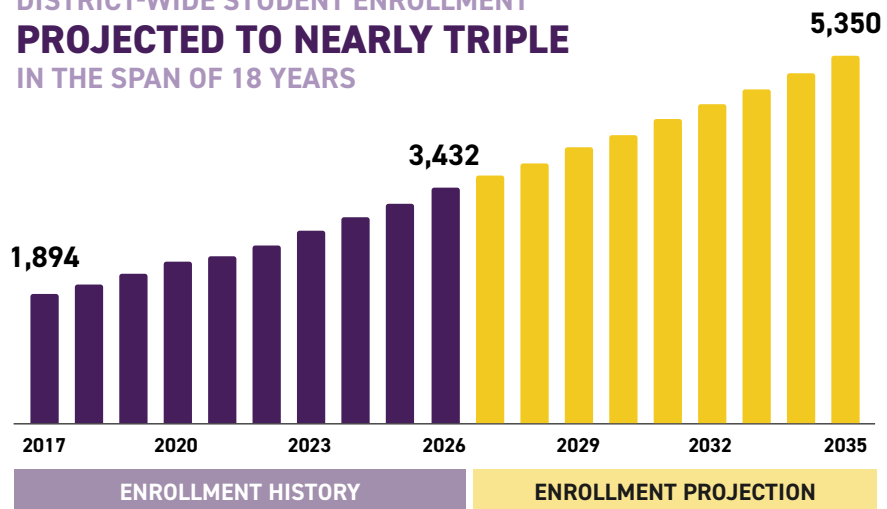

FIRST OF ITS KIND

A major challenge was the lack of true precedent for this type of combined facility within a similar district. The design team traveled to Little Rock, Arkansas to study a comparable project, but it fell short of the scale, integration, and educational vision Godley required. The team developed a solution uniquely tailored to the district's goals.

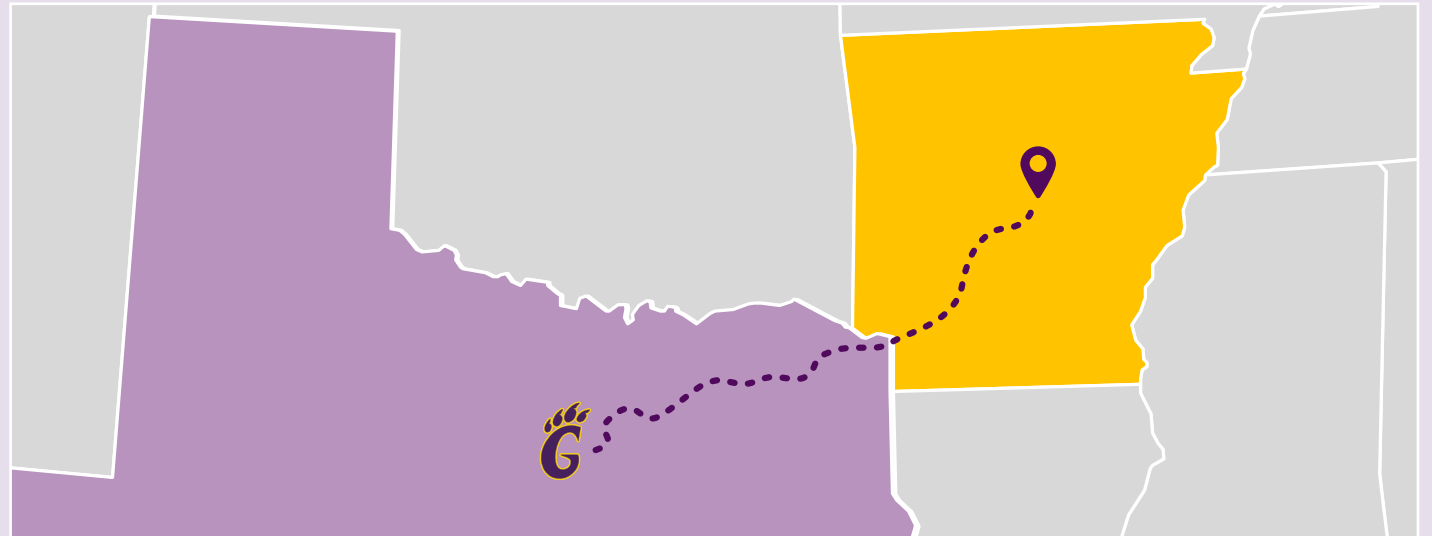

PHYSICAL ENVIRONMENT

Levels of Learning

A central focus for The WILD was maximizing the use of district facilities to directly support learning. Rather than limiting specialized spaces to single-use or occasional programming, the district aimed to create an environment where instruction, exploration, and hands-on application could happen daily and at full capacity. This approach supports a broader goal of increasing student engagement in CTE pathways while ensuring equitable access to high-quality programming.

LEGEND

- CTE Labs
- Classrooms
- Outdoor Learning
- Multipurpose Rooms
- Administration

FIRST FLOOR



SECOND FLOOR

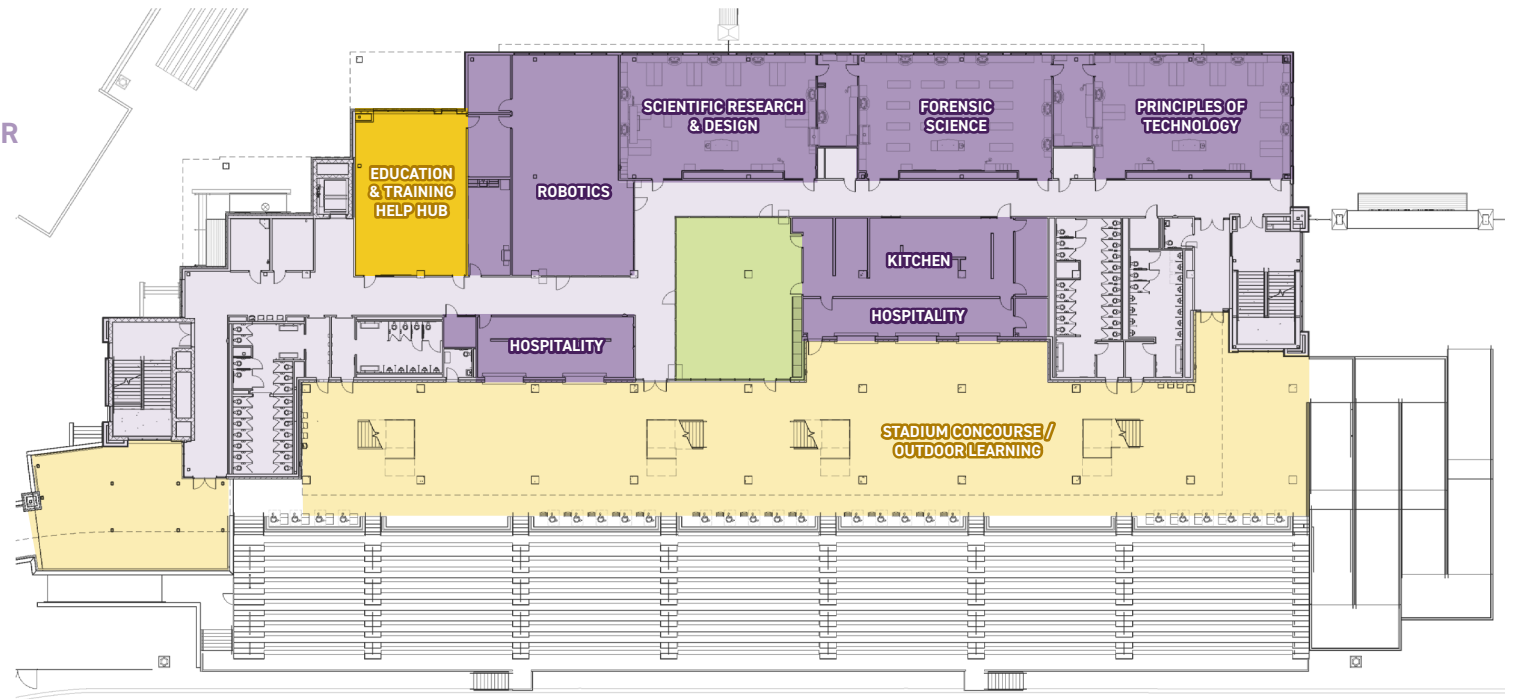

PHYSICAL ENVIRONMENT

Every square foot was designed to serve **students first**, with the **flexibility** to support community events.

THIRD FLOOR

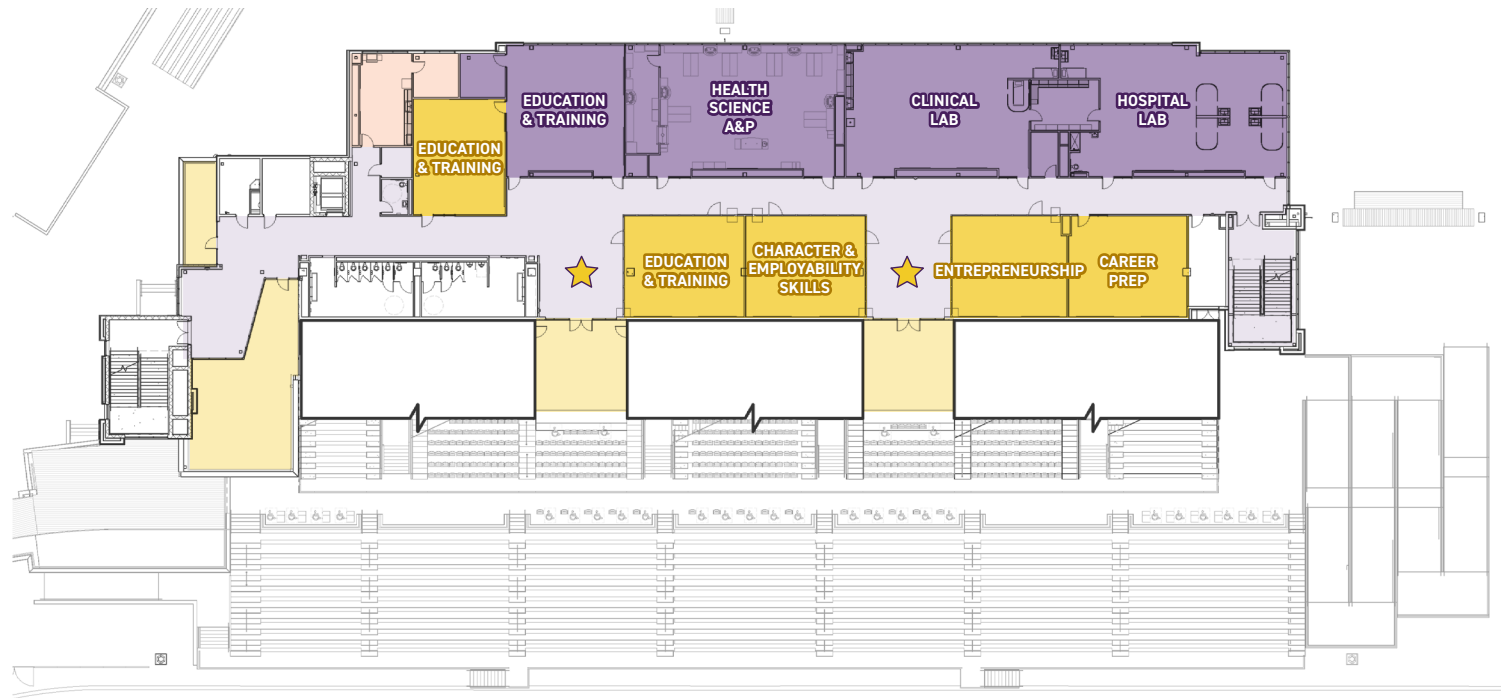

FOURTH FLOOR

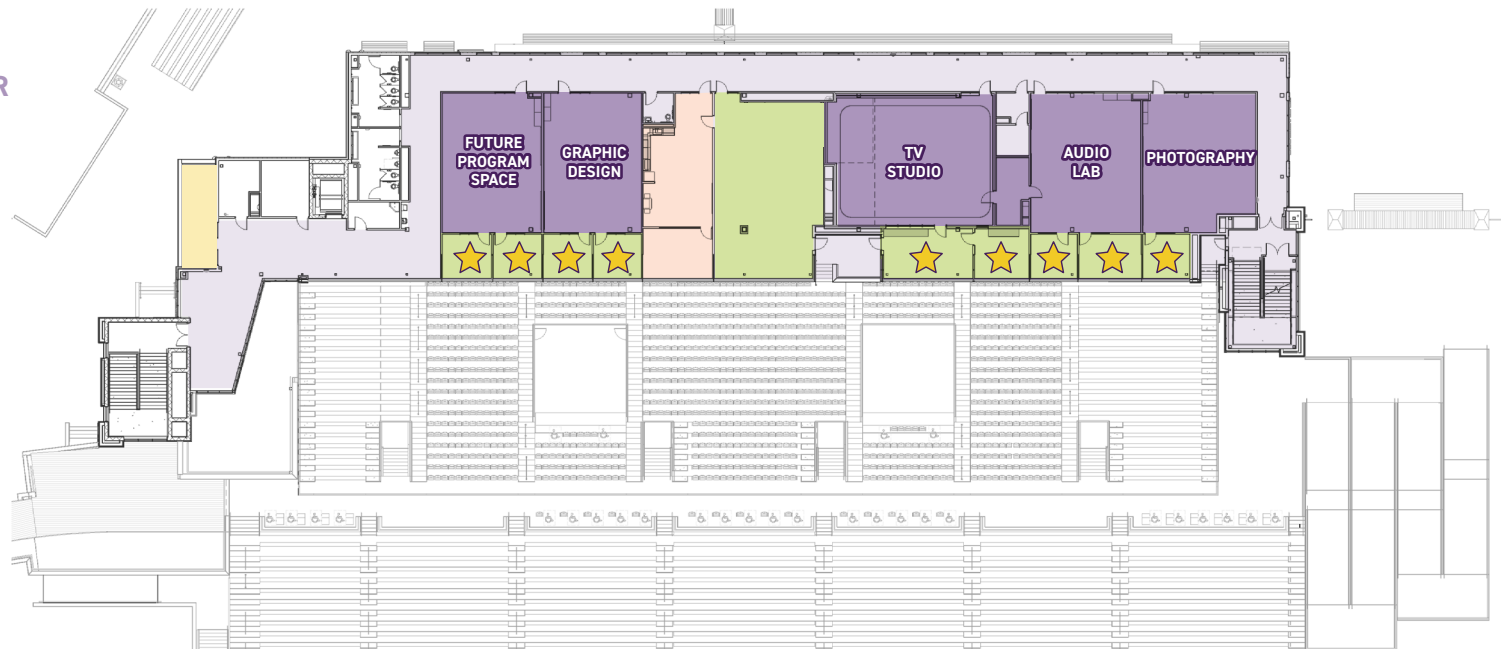

LEGEND

- CTE Labs
- Classrooms
- Outdoor Learning
- Multipurpose Rooms
- Administration
- Collaboration Space

Built for ALL Students

The beauty of The WILD is that it was created for all students, all the time. Not just a football stadium, it acts as a flexible, future-ready learning environment where academic programs, CTE pathways, and athletics intersect. With the four-story CTE wing built directly into the home side of the stadium, the building itself becomes a living demonstration of how learning and real-world experience can coexist.



The WILD allows us to offer programs to our kids that we just weren't able to before.

DR. RICH DEAR, GODLEY ISD SUPERINTENDENT

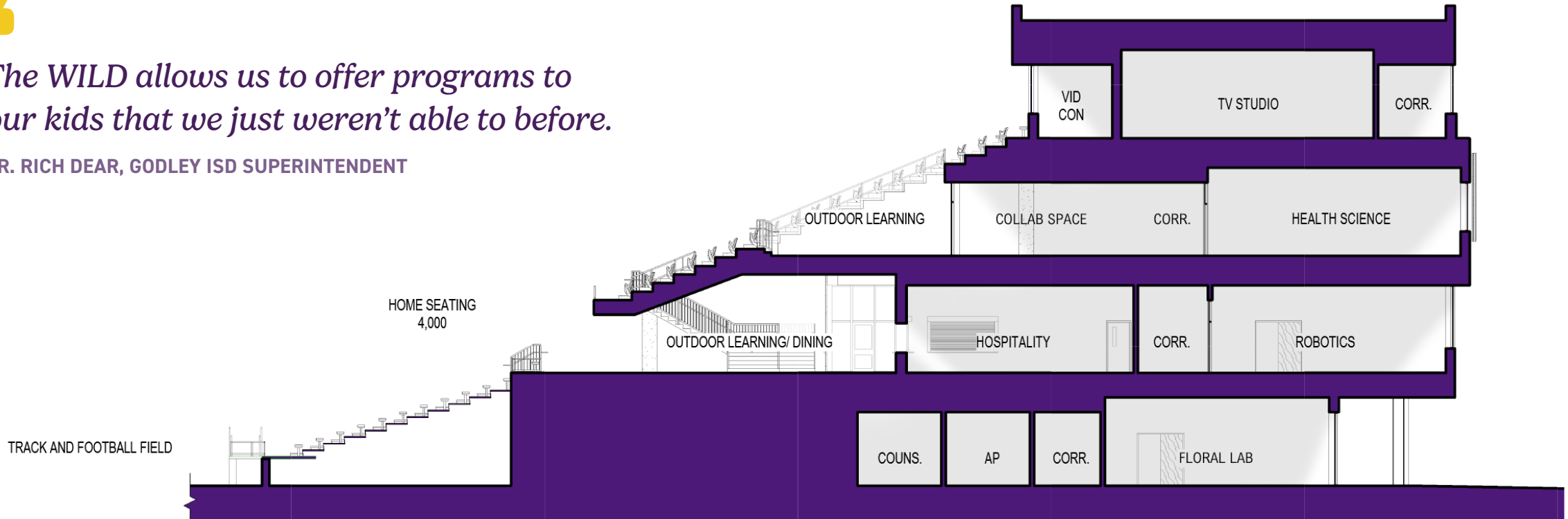

PHYSICAL ENVIRONMENT



Press Box / Multipurpose



TV Studio



Culinary Lab



Hospital Lab



Spirit Store



Floral Lab

PHYSICAL ENVIRONMENT



The Building Influences the Curriculum

At The WILD, the building itself drives the curriculum. Purpose-built, hands-on spaces allow students to fully immerse themselves in learning, explore their interests, and still have the flexibility to change direction as they discover what truly fits. Students see what is possible every day, not as an idea but as real work happening around them. Where staff once made do with limited, general-use rooms, they now teach in specialized environments designed for the work itself. Spaces like the welding lab provide the proper ventilation, equipment, and scale needed to teach authentic techniques safely and effectively. Beyond technical skills, students develop customer service, communication, and interpersonal skills through real interactions with peers and the community, contributing in meaningful ways while preparing for life beyond graduation.

Career programs give students the opportunity to discover what excites them—but just as importantly, what may not be the right fit. As Nikki Nix, Chief Academic Officer, shared, “Sometimes students enter a career program and say, ‘I don’t know if this is for me.’ And for me, that is just as much a success as a student trying a program and falling in love with it.” By exploring different pathways early, students gain valuable clarity and confidence about their future.

“

The facilities are actually driving the programs. And as a result of the experience in these spaces, we’ve already had kids earn scholarships and accolades for learning these skills.

DR. RICH DEAR, GODLEY ISD SUPERINTENDENT

PHYSICAL ENVIRONMENT

No Idle Space

34% of The WILD's academic learning area is **dual-purpose**, supporting both daily instruction and event use.

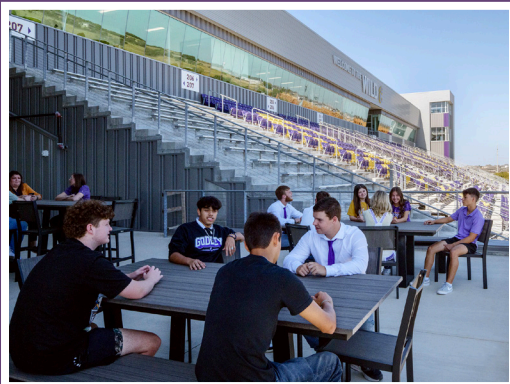

FIRST FLOOR

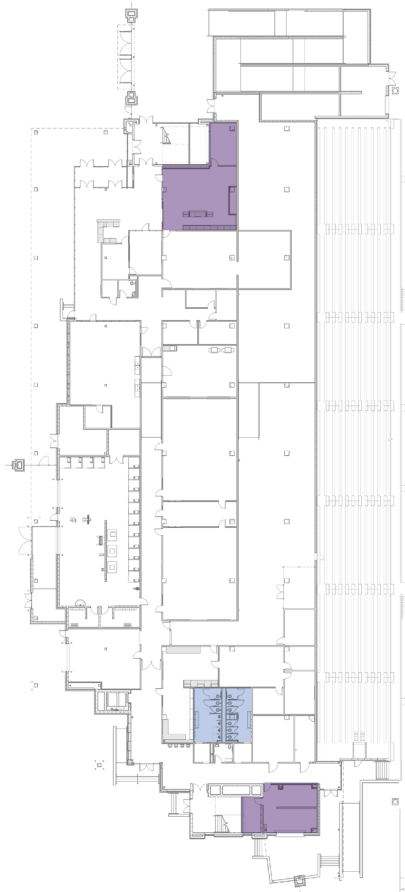

SECOND FLOOR

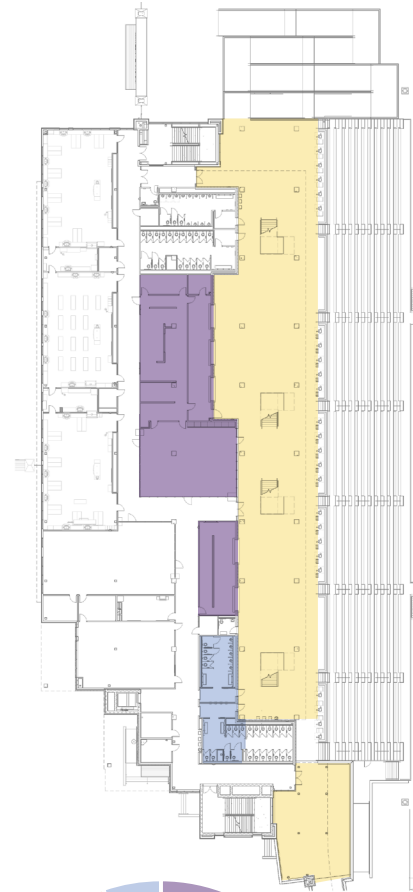

THIRD FLOOR



FOURTH FLOOR



BREAKDOWN OF MULTI-USE SPACES

- Shared Indoor Spaces
- Shared Outdoor Spaces
- Shared Restrooms

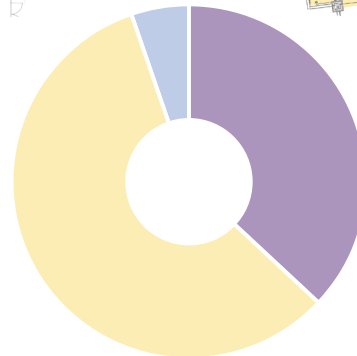

The 26,655 SF of multipurpose space is designed to flex between daily student learning and game day or community use.

It includes 9,878 sf of indoor multipurpose space, 15,405 sf of outdoor learning areas, not including the field, and 1,372 sf of restrooms that serve both students and after-hours events.

EDUCATIONAL ENVIRONMENT

Step into The WILD

At first glance, it looks like a stadium. In practice, The WILD is a dynamic learning destination where students prepare for life after graduation.

WHY IT WORKS

The WILD engages students in a new way by creating hands-on learning environments where they can explore their passions and connect learning to future careers. Designed to support new teaching and learning styles, the facility encourages collaboration, flexibility, and real-world application. These spaces give students greater autonomy in shaping their learning path.



The **Entrepreneurship** class centers on a fully operational campus store, where merchandise is developed, produced, and sold. Open during school and game day hours, the space supports real-world business experience while reinforcing school identity.



The **welding lab** supports hands-on learning, where fabricated pieces can be sold in the campus store. This connection links production to real-world retail, extending learning beyond the lab.



IT students handle all Chromebook repairs in-house, generating enough cost savings to offset a teacher's salary while gaining hands-on technical experience.



Students in **Broadcasting Media** are transferring their skills from the classroom, directly to game day filming operations within the same room!



Floral Design students gain certification and get to sell their creations in the store. Creative, entrepreneurial, and interpersonal skills are developed within one program.



Transportation, Distribution, & Logistics classes learn to operate drones both indoors and outdoors. Some students have been hired by local real estate agents to capture marketing footage of properties in Godley.

EDUCATIONAL ENVIRONMENT



Space for Everyone

The building demonstrates a commitment to inclusion, where every student, whether in a core class, a CTE program, or an athletic team, has access to spaces that support their learning, their interests, and their future.

The WILD houses programs in agriculture, health science, engineering, business, and more, each with dedicated labs and classrooms that serve dual purposes. On game days, the AV classroom and their connected spaces transform into the press box, giving students authentic experience in sports media, broadcasting, and event production. During the school week, those same indoor and outdoor collaboration areas become gathering spaces for students across all programs — and on weekends, they become unique viewing spots for spectators.

“

I have everything that I need to work with (for my career path) and I don't have to worry about not having the materials I need.

GODLEY ISD STUDENT

EDUCATIONAL ENVIRONMENT

Flexible Spaces From Day to Night

Because the CTE wing is integrated into the stadium, students support nearly every aspect of its operation. Embedding CTE here increased capacity, expanded certification opportunities, and created a multipurpose space active seven days a week.

MORE THAN ATHLETES AND SPECTATORS

Students from a variety of programs participate in game day experiences.

- Athletics
- Band
- AV
- Robotics (Drones)
- Hospitality / Culinary
- Entrepreneurship

SEE HOW THESE SPACES TRANSITION FROM DAYTIME LEARNING TO ATHLETICS USE.

The second-level walkway connecting The WILD to the main campus serves as both a space for learning and connection, transforming into a prime viewing destination on game days.

The field is a useful tool for measuring long distances in experiments and is great access to outdoor space for students throughout the day.

The concourse walkways double as crime scene investigation labs for Criminal Justice classes, then convert into home-side stadium seating for games and community events.

Students collaborate in small-group workrooms filled with natural light, designed to flex on game days when athletics gets to “borrow” the space for indoor viewing. The same rooms also support media production.



EDUCATIONAL ENVIRONMENT



The Duality of The WILD

The WILD is both an exceptional educational space and a high quality athletics venue, but it is not a 50/50 compromise. Academics drive the design. Classrooms, labs, and collaboration spaces are intentionally designed to function first as places for teaching and learning, then seamlessly transform for game day use. This duality allows students to apply skills in real time, whether through media production, event operations, or crowd engagement. The result is a facility where education leads and athletics amplify. The building's duality is both practical and cost-effective. Restrooms serve students during the day and remain accessible after hours, reducing the need for a separate fieldhouse facility. On the concourse level, the hospitality space doubles as a culinary classroom and game day concessions.

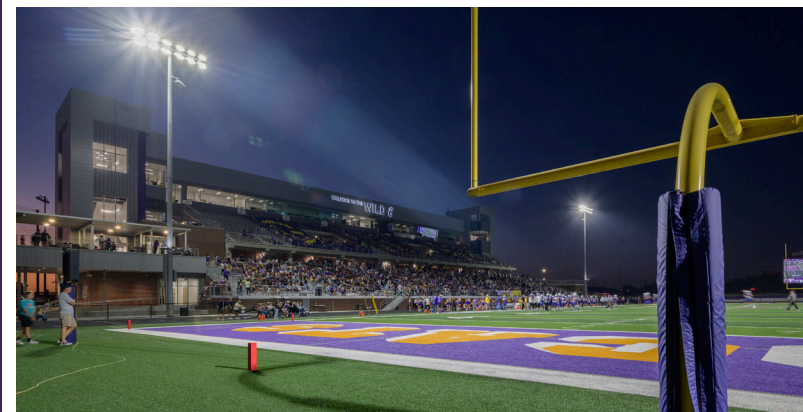

Real Results

Don't just take it from us, hear directly from Godley ISD students on their experience in The WILD.



“

I'm thinking about going into biological systems engineering, so doing this has really given me a chance to hone in on that and what that career really is.

NOLA BRISCOE, STUDENT
Scientific R&D (Health Sciences)



“

I chose AV because it gives me the ability to put creativity into the work that I do. When I get out of high school I want to become a director in film, so it's really building up all those strengths that I need.

MYA AREVALO, STUDENT
Multimedia Arts (Arts, AV Technology, & Communications)



“

I'm in the education pathway, I chose it because I want to be a coach in the future. I'm the first one that's ever done the coaching aspect of it and having so many teachers and educators in my corner has been super helpful in getting my program done.

KEEGAN BOHANNON, STUDENT
Teaching & Training (Education & Training)

Supporting a Diversity of Learning and Teaching Styles

Multipurpose spaces like these reflect the intentional design behind every square foot of The WILD. Flexible furniture and direct outdoor access support hands-on, adaptable learning experiences.

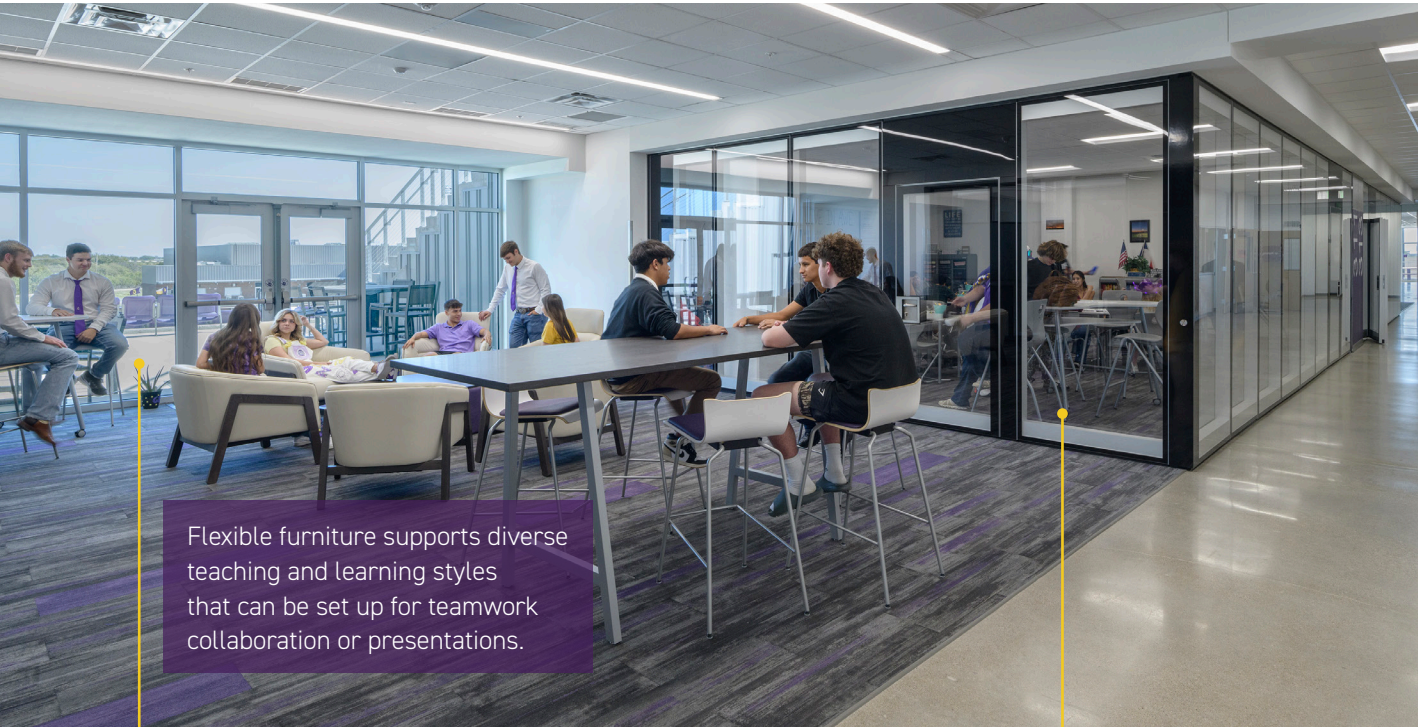

Flexible furniture supports diverse teaching and learning styles that can be set up for teamwork collaboration or presentations.

This room has a direct connection to outdoor learning spaces on the stadium side at the third level. This also provides great natural daylight into the learning space.

Operable partitions allow classrooms surrounding the space to expand as needed.



These walls can be opened, expanding the robotics lab to set up large obstacle courses for robots and drones to navigate.

This second level multipurpose space can be used as dining for the future culinary program or for group project collaboration.

Strategic Use of Light and the Outdoors

An entire CTE center tucked below stadium seating would not have been a productive environment for learning. The design team got creative with bringing in daylight and outside learning areas that could motivate students and staff.

The entire west side of the building brings in daylight.

Physics classes use these balconies for egg drops. The egg has to survive drops from the 2nd, 3rd, and 4th levels. After school, they're great viewing platforms for softball games.

These patios can be used throughout the day at multiple levels by any CTE program.



On the fourth floor, through these windows you can see the space that converts from classrooms to press box space on game day.

These seating areas between the GHS connect directly to indoor collaboration spaces filled with natural light from large windows, supporting an easy flow between indoor and outdoor learning.

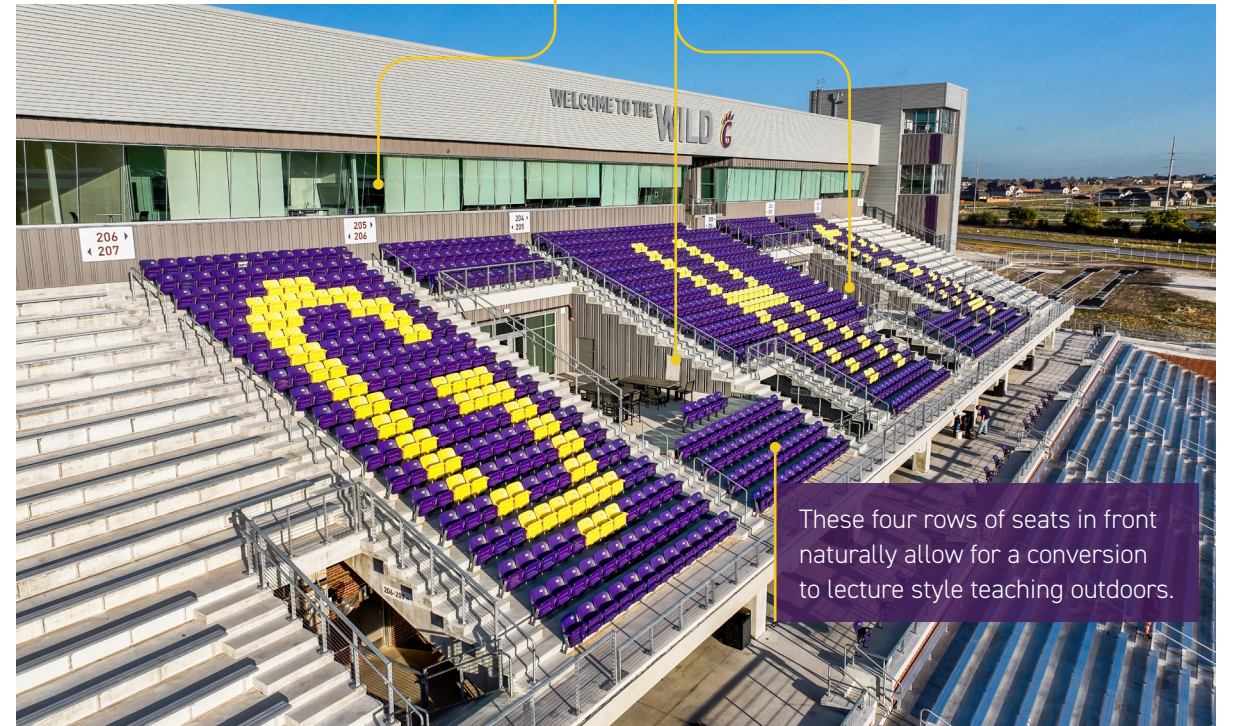

These four rows of seats in front naturally allow for a conversion to lecture style teaching outdoors.

RESULTS

Meeting the Needs of the District and the Community

Each year, elementary students tour The WILD, sparking early excitement about their future. They can already see themselves in careers that would normally never be exposed to them. These experiences support Godley ISD's Pre-K to Professionals initiative by helping students envision long-term pathways years before they enter the building.

For students in grades 9–12, The WILD becomes a critical part of that journey, offering real experiences that build confidence and direction. As one student shared, "We have so much opportunity." Through hands-on learning, certifications, and applied experience, students graduate set apart from other candidates, equipped with the skills and credentials that give them a clear advantage beyond other high school students.

BUILDING FUTURES

Through hands-on learning and real responsibility, The WILD connects students directly to their community, creating a hiring pipeline to the community that benefits both graduates and local employers.

“

Our students become contributing citizens right here to our small town that we love.

NIKKI NIX, GODLEY ISD CHIEF ACADEMIC OFFICER



RESULTS

Unintended Results, Setting the Standard

Godley ISD now stands as an example of what's possible when districts think differently about how space can serve their communities. By embracing a multi-use approach, the district proactively addressed evolving needs while maximizing value for students, citizens, and taxpayers. This project demonstrates a new way forward—one that challenges traditional models and has the potential to influence how schools across Texas are designed in the future.

This style of building creates more value for students, citizens, and taxpayers. This project will forever impact how people design schools in Texas. This proves, we CAN do things differently and share these spaces, creating multipurpose facilities that save money and act more proactively in addressing needs of the district.

IMITATION IS THE BEST FORM OF FLATTERY.

26 school districts and counting
have come to tour The WILD, looking to create something similar in their district.



RESULTS

Stretching Bond Dollars Further

This was not the original vision for Godley ISD's CTE education. The WILD emerged from a deliberate focus on maximum utilization, student success, and responsible stewardship of taxpayer dollars. By rethinking how academic and athletic spaces could work together, the district discovered that one facility could serve more students, more programs, and more communities without duplicating space. The result is an innovative model that prioritizes learning first, uses every square foot with purpose, and proves that districts can do things differently while saving money and expanding opportunity.

The district saved over \$55 million

by combining CTE and athletics into one facility, creating opportunities to offer more programs for students.

THE WILD | WILDCAT INNOVATIVE LEARNING DESTINATION

Huckabee
a MOREgroup brand

